

17 December 2014

Works Notice - Hospital Corner and surrounding streets



As you know, Downer has been working on Hospital Corner and surrounding streets. This notice is to let you know what we will be doing over the holiday season, and to give you an update on progress.

We will be closing down our work sites over the holiday season. Our last day of work will be Tuesday 23 December. We will be back on Monday 5 January 2015.

During this time the work site will be closed down and traffic management will be removed.

Work in 2015

Monday 5 January 2015 to 8 January 2015

We will be working on Tuam Street, between Antigua Street and the Hospital Corner. This work will involve removing line marking and re-painting line marking. This will convert Tuam Street to oneway traffic, travelling east towards the city.

Traffic Impacts:

Tuam Street will be closed to traffic between **Antigua Street** and **Hospital Corner**.

Vehicle access to business employees will be maintained as much as possible by traffic controllers on site.

Where we are working:

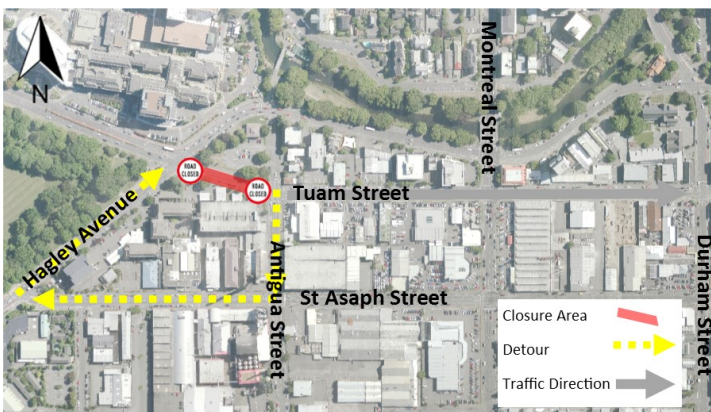

Sourced from LINZ data, Crown Copyright reserved

Thursday 8 January 2015

We will be working on Oxford Terrace, between Hospital Corner and Montreal Street. This work will involve removing line marking and re-painting line marking.

Traffic Impacts:

There will be lane drops on Oxford Terrace, between **Hospital Corner** and **Antigua Street** from 8 January 2015 to 12 January 2015.

Oxford Terrace will be closed between **Antigua Street** and **Montreal Street** from 12 January 2015 to 16 January 2015.

Vehicle access to business employees will be maintained as much as possible by traffic controllers on site.

Where we are working:

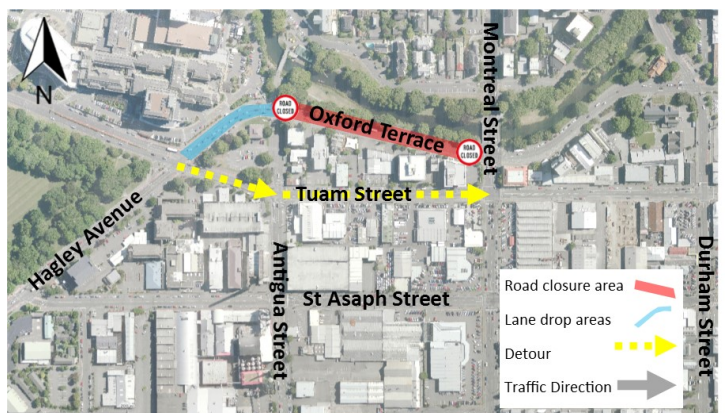

Sourced from LINZ data, Crown Copyright reserved

Need more information?

Phone: 0800 400 310 (8.30am - 5.00pm. Monday - Friday) Email: eqinfo@downer.co.nz