

We're rebuilding Akaroa Wharf

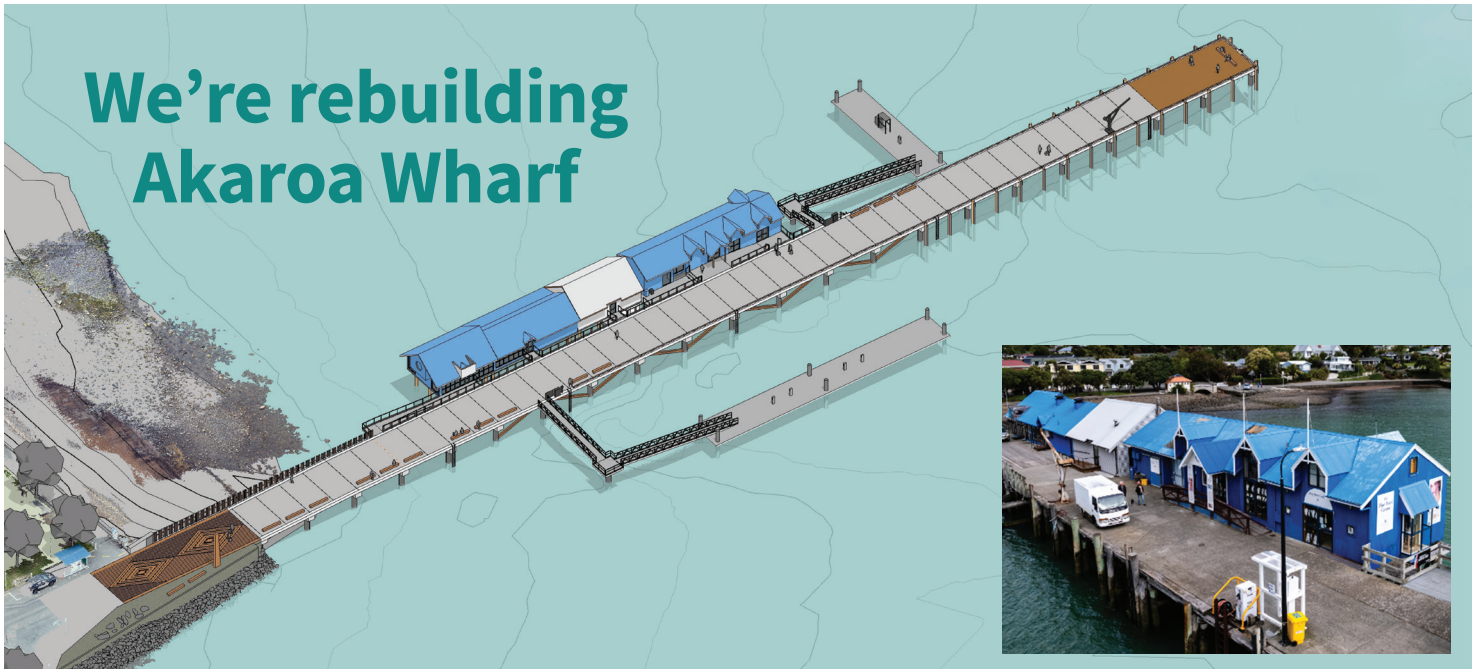

The Akaroa Wharf, originally constructed in 1887, is an iconic landmark for the town with significant cultural, historical and social value for the community. It is important recreationally and commercially to Akaroa, as well as the wider Canterbury region.

A structural report in 2018 identified the wharf is reaching the end of its life. Public consultation was held in 2021 and 2022, and Christchurch City Council has now lodged the resource consent to rebuild the 137-year-old wharf.

Key features of the new wharf:

- Similar footprint – 185m long and 8m wide.
- Rebuilt in approximately the same location, shifted 2 metres to the north.
- Retain pedestrian connections to the existing buildings which will remain in their current state.
- Contain two floating pontoons arranged on the northern and southern faces of the wharf.
- Pontoon services include power, water and diesel.
- Wharf materials include timber decking at the beginning and outer end, brushed concrete to central areas, timber fender piles and timber deck elements.
- Design features throughout reflecting mana whenua and the history of the wharf.



During construction

Construction works will take place over an 11-to-14-month period and begin when consents are granted. Works are planned to run from early 2026 to mid 2027.

The southern end of the Recreation Grounds will be fenced off for storage and workspace and there will be an area of temporary land reclamation by the Akaroa boat ramp to allow the barge to load and unload from this point. These areas will be restored following the works.

Most construction materials will be barged between the boat ramp and the wharf but some construction vehicles will need to use the Akaroa transport network at times.

The work will generate noise and vibration within the harbour. A Construction Noise and Vibration Management Plan will be in place to ensure noise impacts are minimised.

Hector's Dolphins will be protected during the works with piling works paused while dolphins are in the area.

Find out more

A wide range of information about the project can be found on the Christchurch City Council website.



Please visit

ccc.govt.nz/akaroa-wharf

Got questions?

Please email the project team at AkaroaWharfProject@ccc.govt.nz

We're rebuilding the Akaroa Wharf

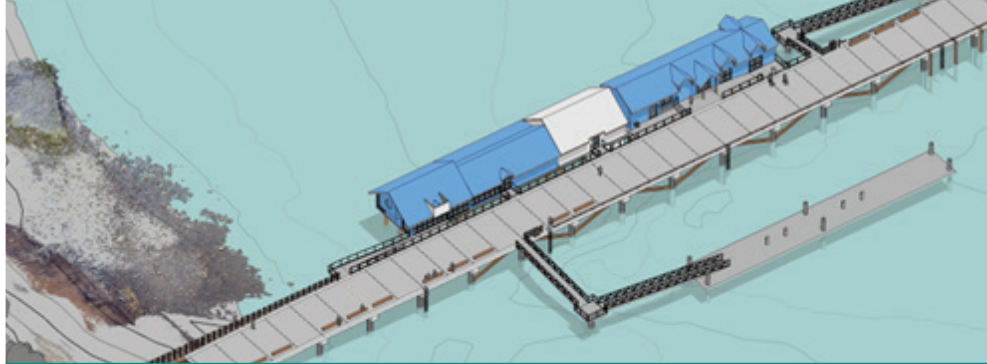

Here's what you need to know

The Akaroa Wharf, originally constructed in 1887, is an iconic landmark for the town with significant cultural, historical and social value for the community. It is important recreationally and commercially to Akaroa, as well as the wider Canterbury region.

A structural report in 2018 identified the wharf is reaching the end of its life. Public consultation was held in 2021 and 2022, and Christchurch City Council has now lodged the resource consent to rebuild the 137-year-old wharf.

The new wharf will be:

- Rebuilt in approximately the same location, shifted 2 metres to the north.
- Rebuilt with a similar footprint – 185m long and 8 metres wide.
- Retain pedestrian connections to the existing buildings which will remain in their current state.
- Contain two floating pontoons arranged on the northern and southern faces of the main wharf.
- Pontoons services include power, water and diesel.
- Wharf materials will include timber decking to the beginning and outer end, reinforced concrete decking and piles, timber fender piles and timber deck elements.
- Design elements throughout acknowledging mana whenua and the history of the wharf.



Recreation Grounds area

- 3.1 Barge loading area
- 3.2 Site office
- 3.3 Welding and laydown yard
- 3.4 Overflow storage

During construction

Construction works are anticipated to take place over an 11 to 14-month period and will require the use of laydown and storage areas located within Akaroa township.

The southern end of the Rec Grounds will be fenced off for storage and work space and there will be an area of temporary land reclamation by the Akaroa Boat ramp to allow the barge to load and unload from this point. These areas will be restored following the works.

Most of the construction materials will be barged to the site, but some large construction vehicles will need to use the Akaroa transport network at times. A traffic management plan will be in place to manage this.

The work will generate some noise and vibration within the harbour and a Construction Noise and Vibration Management Plan (CNVMP) will be in place to ensure noise impacts are minimised.

Hectors Dolphins will be protected during the piling with spotters in the area and works being paused if dolphins come too close. Timber salvaged from the wharf will be reused in the new wharf and also given to the community.

Find out more

A wide range of information about the project can be found on the Christchurch City Council website.



Please visit

ccc.govt.nz/akaroa-wharf

Got questions?

Please email the project team at AkaroaWharfProject@ccc.govt.nz