

© COPYRIGHT CHRISTCHURCH CITY COUNCIL / AERIAL PHOTOGRAPHY CREATIVE COMMONS ATTRIBUTION 3.0 NEW ZEALAND LICENSE

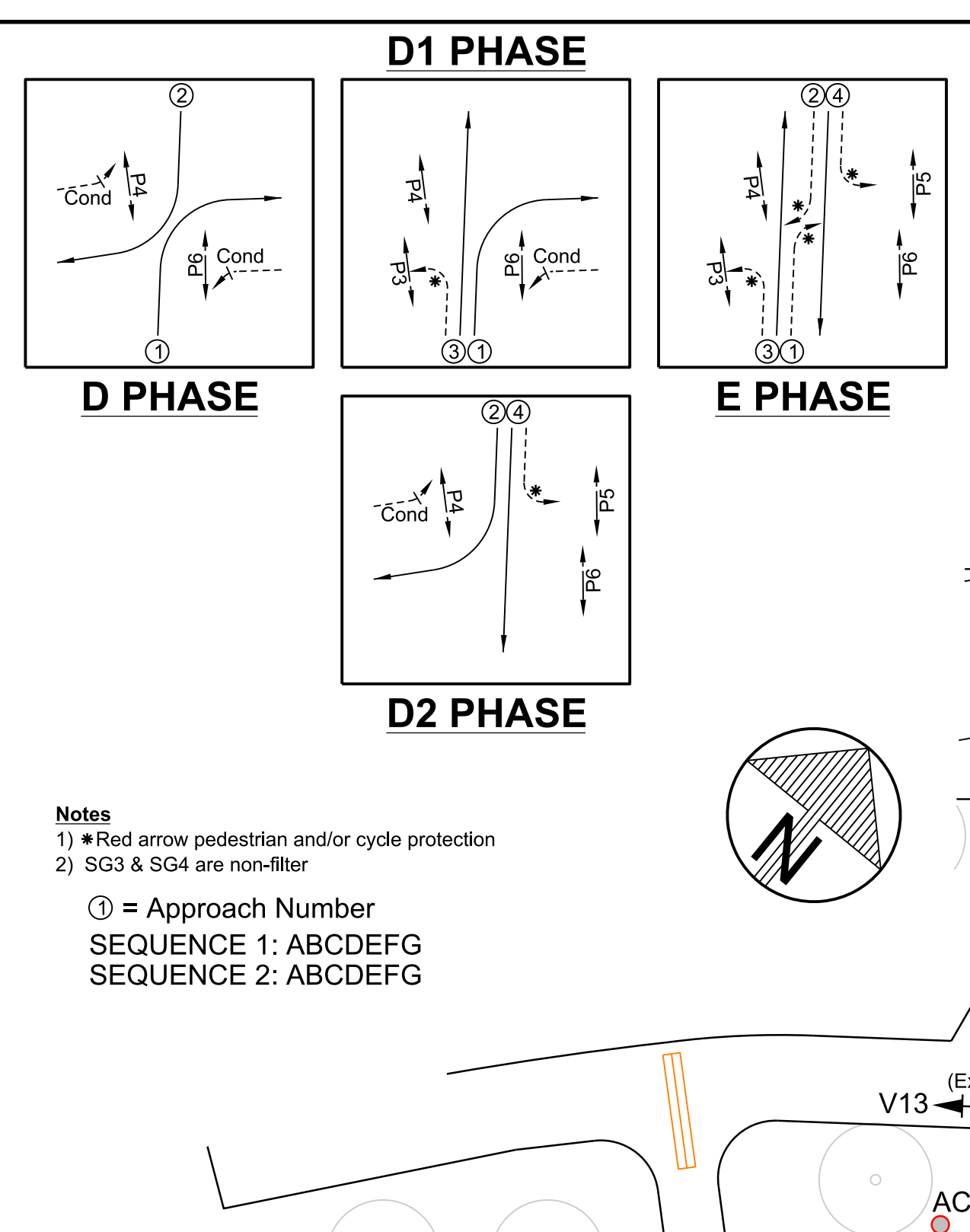

Notes
1) *Red arrow pedestrian and/or cycle protection
2) SG3 & SG4 are non-filter
① = Approach Number
SEQUENCE 1: ABCDEFG
SEQUENCE 2: ABCDEFG

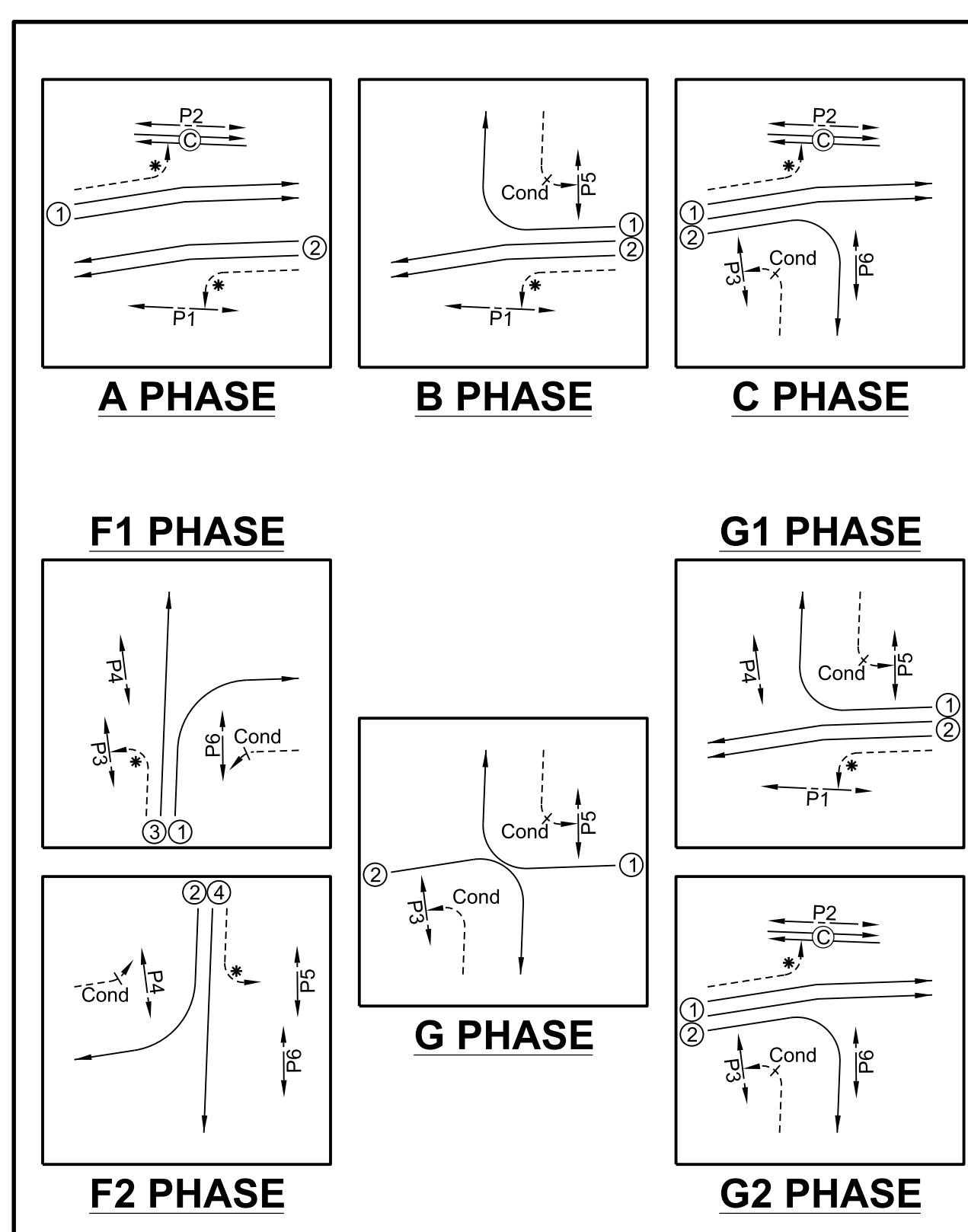
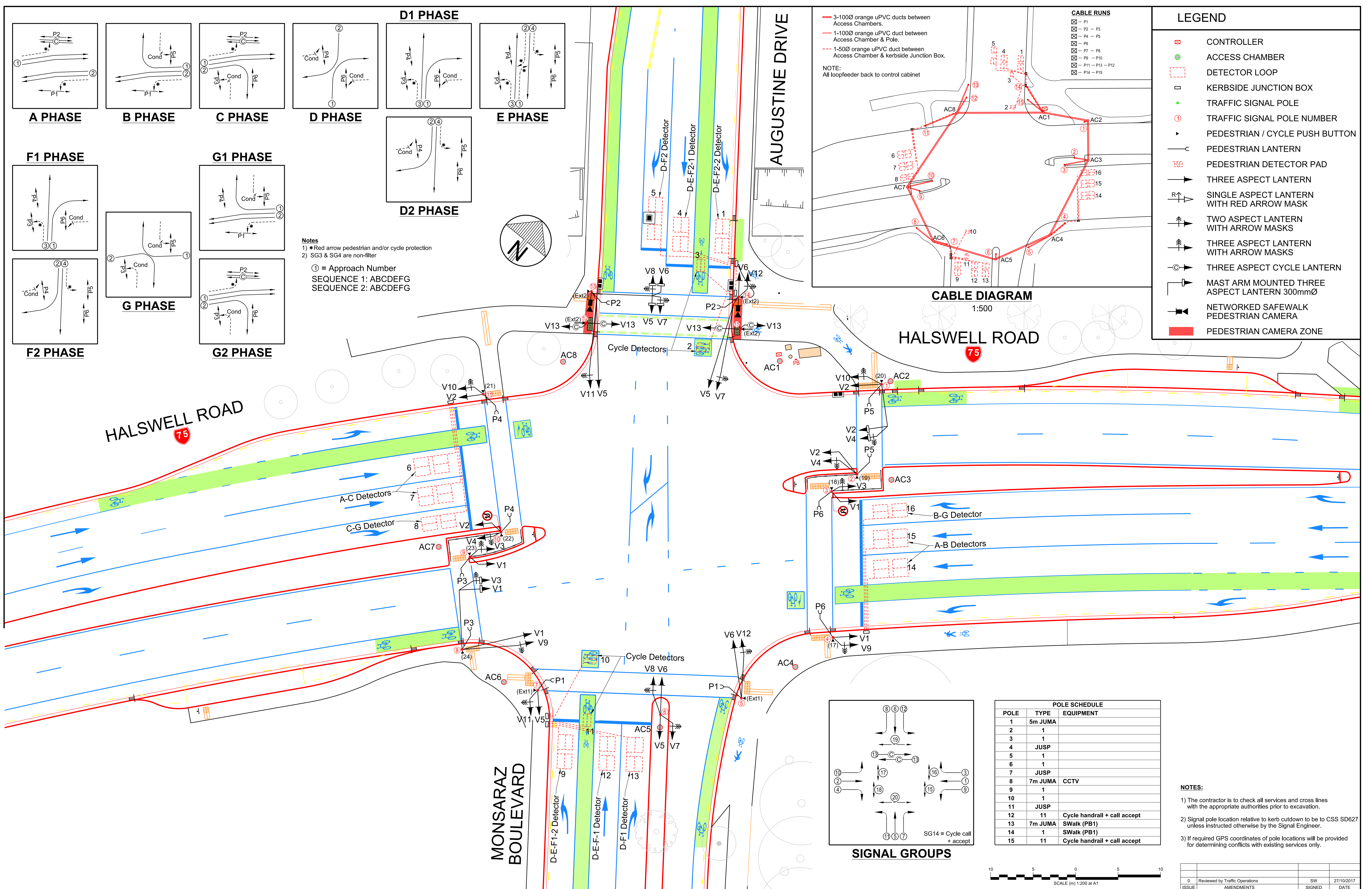
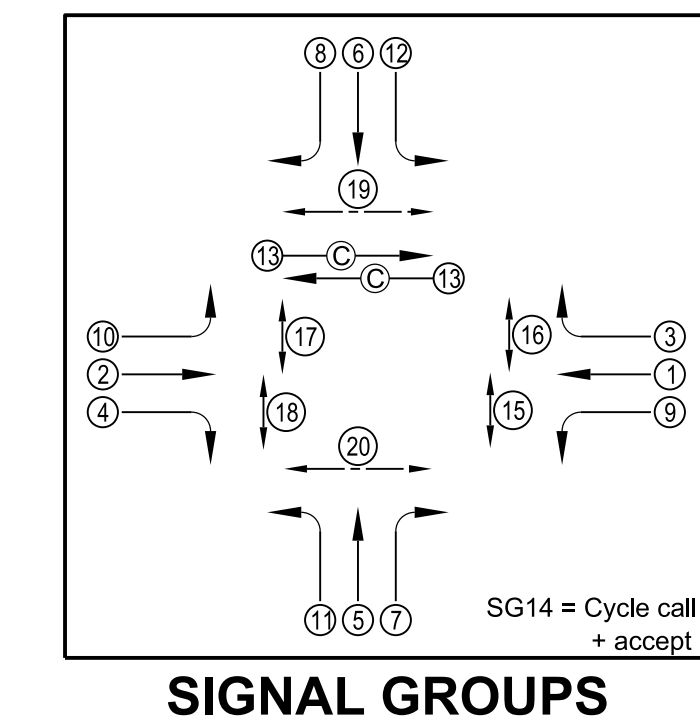
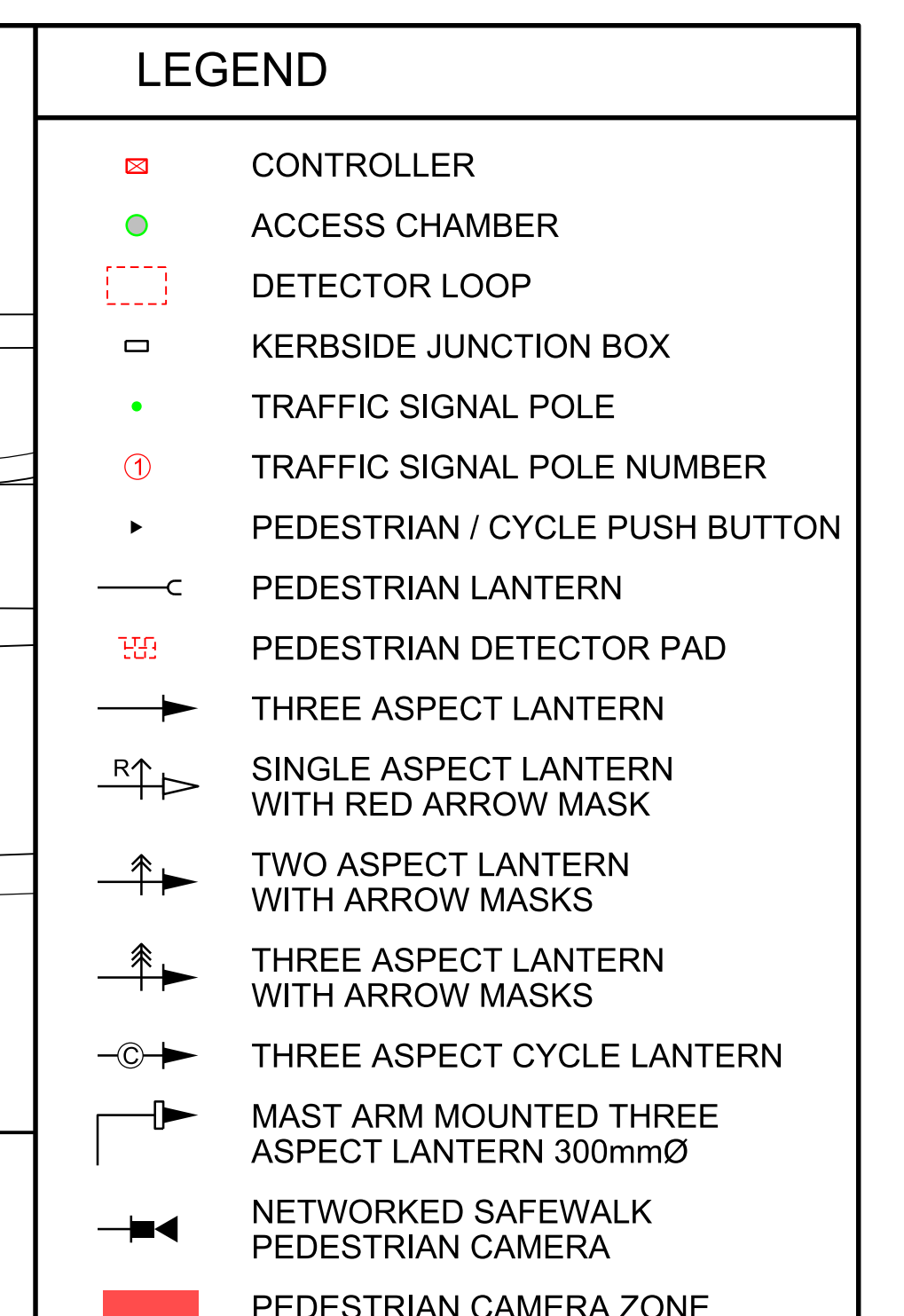
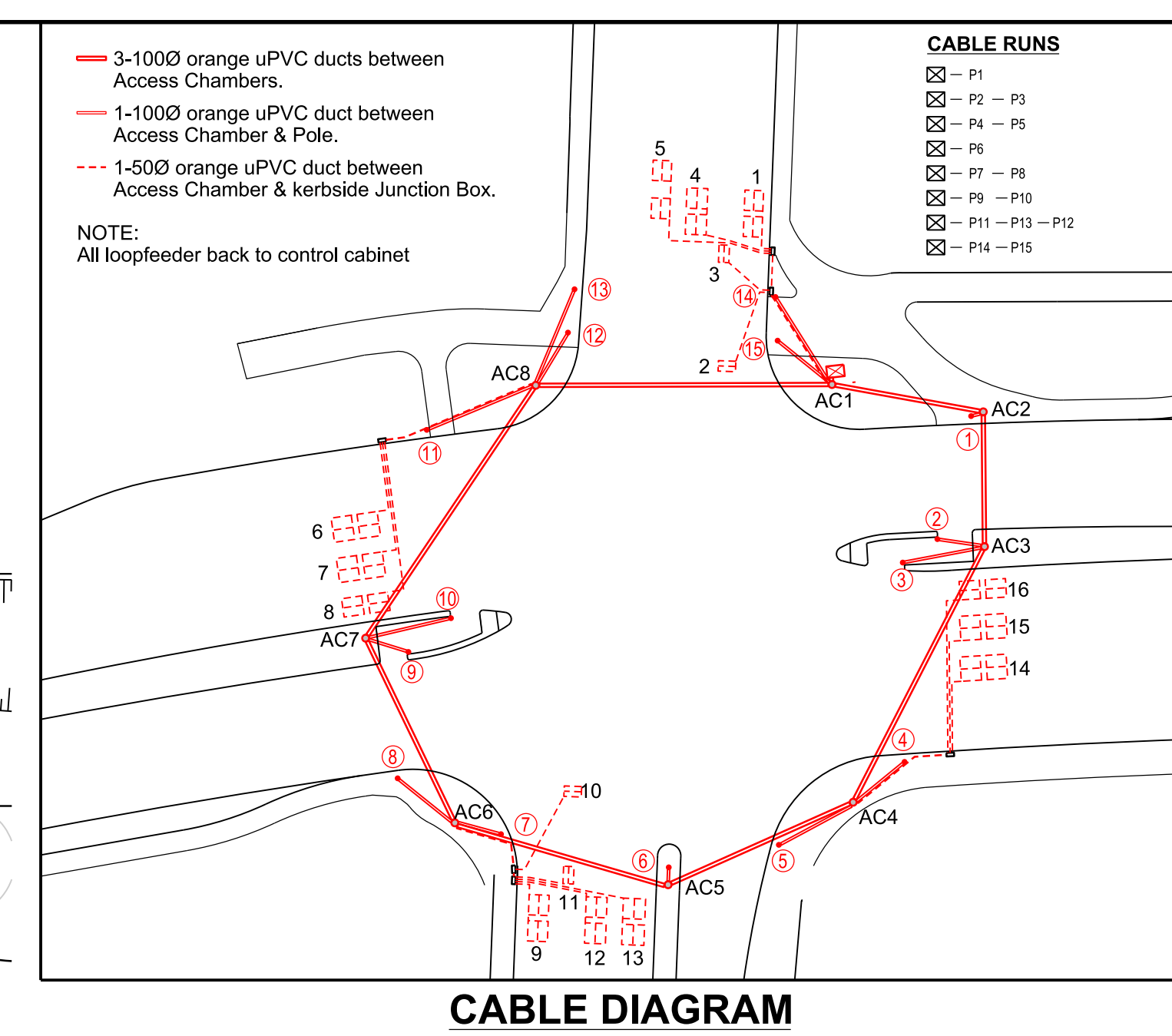

POLE SCHEDULE		
POLE	TYPE	EQUIPMENT
1	5m JUMA	
2	1	
3	1	
4	JUSP	
5	1	
6	1	
7	JUSP	
8	7m JUMA	CCTV
9	1	
10	1	
11	JUSP	
12	11	Cycle handrail + call accept
13	7m JUMA	SWalk (PB1)
14	1	SWalk (PB1)
15	11	Cycle handrail + call accept

NOTES:
1) The contractor is to check all services and cross lines with the appropriate authorities prior to excavation.
2) Signal pole location relative to kerb cutdown to be to CSS SD627 unless instructed otherwise by the Signal Engineer.
3) If required GPS coordinates of pole locations will be provided for determining conflicts with existing services only.